

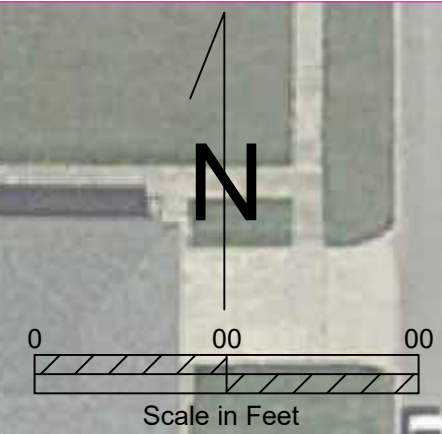

Furnish and Install
4" Asphalt Patches
Core Out Existing Rock

Furnish and Install 4" Asphalt Patches
Core Out Existing Asphalt and Haul away

Edge Of Seal Coat Area



DRAWN BY: CJM	APPROVED BY:	REVISIONS:
DATE: 05/16/18	PROJECT #:	
FIELD BOOK: X	DWG. NAME:	



2601 S. FEDERAL AVE.
MASON CITY, IOWA 50401
Phone: 641-424-1733
Fax: 641-424-0334

PROJECT
New Hampton School Bus Barn

SHEET NAME
Patching Layout

SHEET NO.
1 of 1

PROPOSAL / CONTRACT

HEARTLAND ASPHALT, INC.

2601 S. FEDERAL AVE.
MASON CITY, IA 50401
(641) 424-1733 FAX (641) 424-0334
TOLL FREE 1-800-728-7903 www.HeartlandAsphalt.com

Job No.
Date **May 18, 2018**
Sheet No.
P. O. # : 0

OWNER:

Name:	New Hampton CSD		
Street:	710 W. Main St		
City:	New Hampton		
State:	IA.	Zip:	50659
Phone:	0	Fax:	0

WORK TO BE PERFORMED AT:

New Hampton School Bus Barn Improvments			
Street:	710 West Main St		
City:	New Hampton	State:	IA.
Contact Person:	John Bear		
Home Phone or Other:	641-330-5978		
E-Mail Address:	j_bear@new-hampton.k12.ia.us		

Heartland Asphalt Inc. (Contractor) proposes to furnish the following described work, labor, materials and/or equipment in connection with construction or improvements as specified below. Subbase must be received to within + 0.05 ft and must be stable enough to carry a loaded tandem truck without rutting.

Operations

- 1.) Patches- 4" Patches recommended for the amount of bus traffic this area recieves
Patching price includes coring out patches as well as installing asphalt
- 3.) Seal Coat- Install Double Seal Coat Using MC-3000 Oil and 3/8" Washed Limestone Chips

COSTS: Area 1: Main Sealcoat & Patches

1.)	Furnish and Install 4" Asphtalt Patches (169 ton)	746 s.y. @	\$ 23.10 / s.y. =	\$ 17,232.60
2.)	Furnish and Insall Double Seal Coat	3,150 s.y. @	\$ 5.52 / s.y. =	\$ 17,388.00
Total Cost Area #1:				\$ 34,620.60

COSTS: Area 2- Well Repair Patches

1.)	Furnish and Install 4" Asphalt Patches (127 ton)	560 s.y. @	\$ 23.10 / s.y. =	\$ 12,936.00
Total Cost Area #2:				\$ 12,936.00

NOTE: If soft subgrade is encountered during the excavation process to get base to grade it may need to be over excavated to remove unsuitable soils and Install Base Rock or suitable fill to get subgrade stabilized so we can place asphalt over it. There may be additional costs associated with this at unit prices of \$ 10.00 / C.Y. to Excavate Subbase and Installation of Base Rock at \$25.00 / Ton Final Cost will be based on actual quantities of work completed per item.

Project bid as tax Exempt. Owner will need to furnish tax exempt form appon award

All material is guaranteed to be specified, and the above work to be performed in accordance with the drawings and specifications submitted for the above work and completed in a substantial workmanlike manner for the sum of:

Dollars \$ **47,556.60**

with payments made as follows: **Net upon completion of work unless otherwise noted.**

1 1/2 % per month interest on Balance Past Due.

Any alteration or revision from the above specifications involving extra costs, will be executed only upon written orders, and will become an extra charge over and above the estimate. All agreements contingent upon strikes, accidents or delays beyond our control. Owner to carry fire, tornado, and any other insurance upon above work.

te: Proposal **is for work to be done in 2018 Construction Season ONLY** and may be withdrawn by us if not accepted within **30** days!!!

Heartland Asphalt Inc.

Date: May 18, 2018

By: Colton Meirick Project Manager
Colton Meirick title

ACCEPTANCE OF PROPOSAL

The above prices, specifications and conditions are satisfactory and are hereby accepted. You are authorized to do the work as specified.

Payment will be made as outlined above.

Date: _____

Signature _____
Signature _____

top copy to office bottom copy to owner file copy: _____ estimator copy: _____